



PICKERINGTON

ESTABLISHED 1815

DECK CONSTRUCTION FROM THE GROUND UP

A STEP BY STEP GUIDE

You must first obtain an approval from the Planning and Zoning Department.

Submit 2 copies of your plot plan showing the location of the proposed deck, include all other structures on this plan.

Complete an application describing your project.

Fees are due upon approval.

Next you will need to obtain an approval from the Building Department.

Submit 2 copies of construction plans showing how the deck will be built.

Complete an application describing your project.

Fees are due upon approval.

You may be required to obtain additional approvals if you are located in a unique area of the city, such as a special flood hazard area.

Once your plans have been approved and fees paid you will be issued a permit, this permit gives you legal permission to construct your deck. During construction you will need to have inspections completed at various stages. These inspections include: a footer inspection, a framing inspection and a final inspection.

This packet includes tables that demonstrate various ways to meet building code requirements. Also included in this packet are typical drawings for your use, these drawings demonstrate common building practices and are tools to help you. In no way does this packet suggest that this is the only method available to meet building code.

Please contact the building department if you have any questions, we are here to help you any way we can. Our goal is to make this process as effortless as possible.

Progress and Tradition in our Community

Building Department • 51 East Columbus Street • Pickerington, Ohio 43147 • (614) 833-2221 • Fax (614) 833-2273

www.pickerington.net

Residential Deck Tables

(These tables will help you determine footer size, beam size and span, floor joist size and span, and post size)

Table R 403.4 Minimum Footing Size for Deck Footing without a Roof Load

Diameter	Square	Maximum Tributary load
8"	8 X 8	14 Sq. Ft.
10"	9 X 9	22 Sq. Ft.
12"	10 X 10	31.6 Sq. Ft.
14"	13 X 13	42.8 Sq. Ft.
16"	15 X 15	56 Sq. Ft.
18"	16 X 16	70.8 Sq. Ft.
20"	18 X 18	87.2 Sq. Ft.

Allowable Spans for Floor Joists Based on #2 Southern Pine or Better; 40 Pound Live Load & 10 Pound Dead Load / Sq. Ft.

Joist Size (inches)	Spacing (inches on center)	
2 X 6	12	16
2 X 8	10' 9"	9' 9"
2 X 10	14' 2"	12' 10"
2 X 12	18' 0"	16' 5"
	21' 11"	19' 11"
		24
		8' 6"
		11' 3"
		14' 4"
		17' 5"

Allowable Spans for Beams Based on #2 Southern Pine or Better; 40 Pound Live Load & 10 Pound Dead Load / Sq. Ft.

Beam Size	Tributary load width (feet)									
	4'	5'	6'	7'	8'	9'	10'	11'	12'	13'
2 - 2 X 6	7'	6'	NA	NA	NA	NA	NA	NA	NA	NA
2 - 2 X 8	9'	8'	7'	7'	6'	6'	NA	NA	NA	NA
2 - 2 X 10	11'	10'	8'	8'	8'	7'	7'	7'	7'	7'
2 - 2 X 12	13'	12'	10'	10'	9'	8'	8'	8'	8'	8'
3 - 2 X 8	12'	11'	10'	9'	8'	8'	7'	7'	7'	7'
3 - 2 X 10	15'	13'	12'	11'	10'	10'	9'	9'	9'	9'
3 - 2 X 12	16'	15'	14'	13'	12'	12'	11'	11'	11'	11'

Maximum Post Height Based on #2 Southern Pine or Better; 40 Pound Live Load & 10 Pound Dead Load / Sq. Ft.

Post Size	Tributary Load Area to Post (square feet)				
	31.6	42.8	56	70.8	87.2
4 X 4	10'	10'	10'	9'	8'
4 X 6	14'	14'	13'	12'	10'
6 X 6	17'	17'	17'	17'	17'

Maximum Allowable Tributary Load Area to be Supported by Side Bolt Beam Connections. Based on 40 Pound Live Load and 10 Pound Dead Load / Sq. Ft. Using 4 X 4 or 6 X 6 and 1/2 or 5/8 Bolts.

Number of Bolts	Maximum Tributary Load Area		Maximum Bolts Beam Size
	Maximum Tributary Load Area	Beam Size	
2 - 1/2 inch	35	All	
3 - 1/2 inch	45	2 X 10 or 2 X 12	
2 - 5/8 inch	50	2 X 8, 2 X 10 or 2 X 12	
3 - 5/8 inch	65	2 X 12	

Residential Deck Drawings

General Notes

1. All lumber shall be pressure treated for exterior use.
2. All metal fasteners & hangers shall be G185 galvanized, stainless steel or compatible with the wood treatment.
3. All structural lumber shall be No. 2 Southern Pine, or better.
4. Provide manufacturer installation manuals with all man-made/composite material.
5. All footings shall be cast-in-place concrete with a min. 3000 psi compressive strength.
6. All footers shall extend to frost depth (32").
7. Guards are required at all areas where the deck/porch floor is greater than 30" above grade at any point.
8. Handrails are required on at least one side of each flight of stairs with 4 or more risers.
9. Required handrails shall range from 34" to 38" vertically measured at the nosing.
10. Handrail ends (top and bottom) shall terminate into a post or returned to a post.
11. On stairs with closed risers, treads shall have a projected nosing ranging from $\frac{3}{4}$ " to $1\frac{1}{4}$ ".
12. All treads and risers shall be equal.
13. The deck floor shall be within $8\frac{1}{4}$ " from the top of the door threshold.
14. Guards shall be designed for a 200 lb concentrated load placed along the top rail in any direction, at any point.
15. All separated beams shall receive full depth solid blocking at 24" on center, maximum spacing.
16. This deck construction package is not designed for hot-tub or spa loading.
17. The actual field construction shall match the approved plans. All field changes will require additional plan approval.
18. Plans are to be on site and accessible for the inspectors review at the time of inspections.

Beam to Post Connection Detail

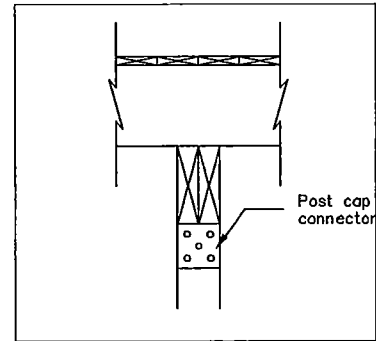
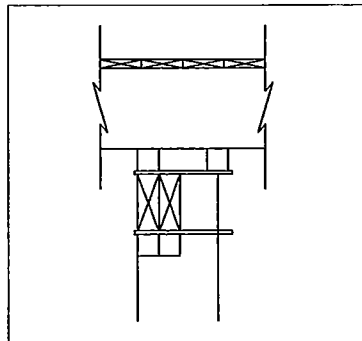
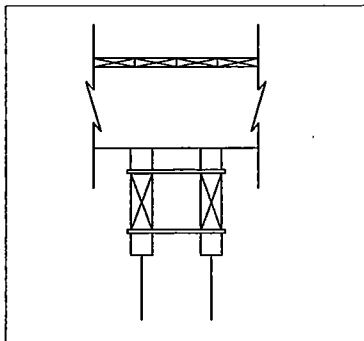

Choose a
Beam to Post
Connection:

[]

[]

[]

Application No.

Sheet No.

1

Residential Deck Drawings



Foundation & Framing Plan

Choose one span configuration:

- Single-Span
- Multi-Span

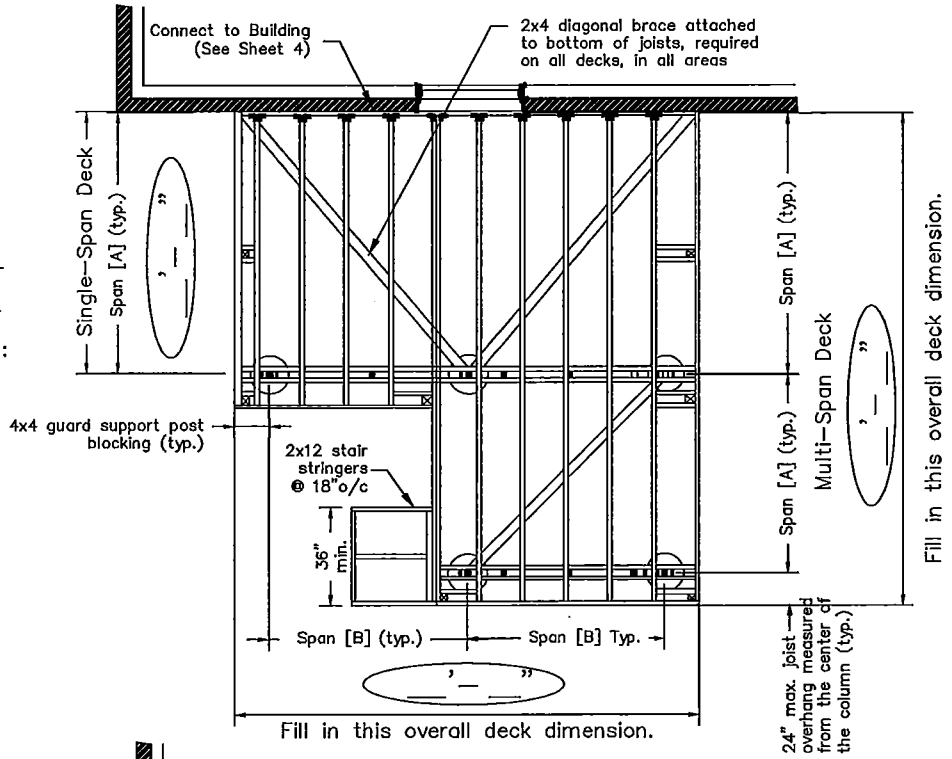

Deck Finished Floor Plan

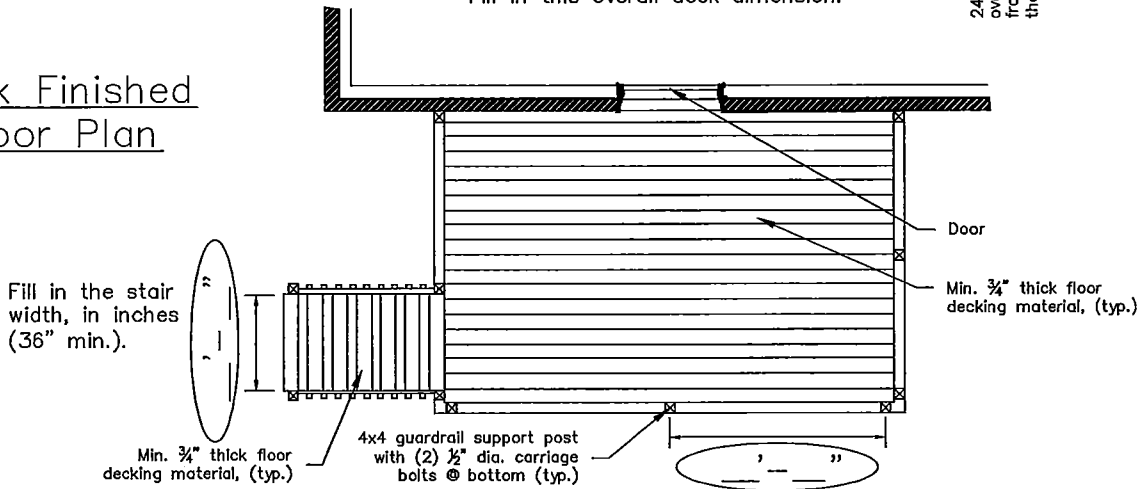

Front Elevation View

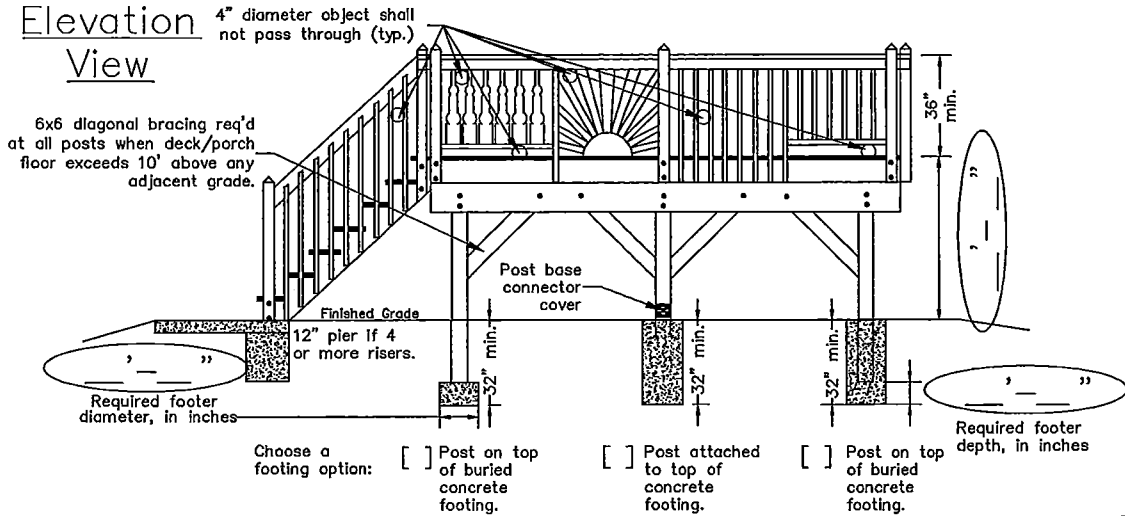

- Choose a footing option:
- Post on top of buried concrete footing.
 - Post attached to top of concrete footing.
 - Post on top of buried concrete footing.

Application No.

Sheet No.

2



Side
Elevation
View

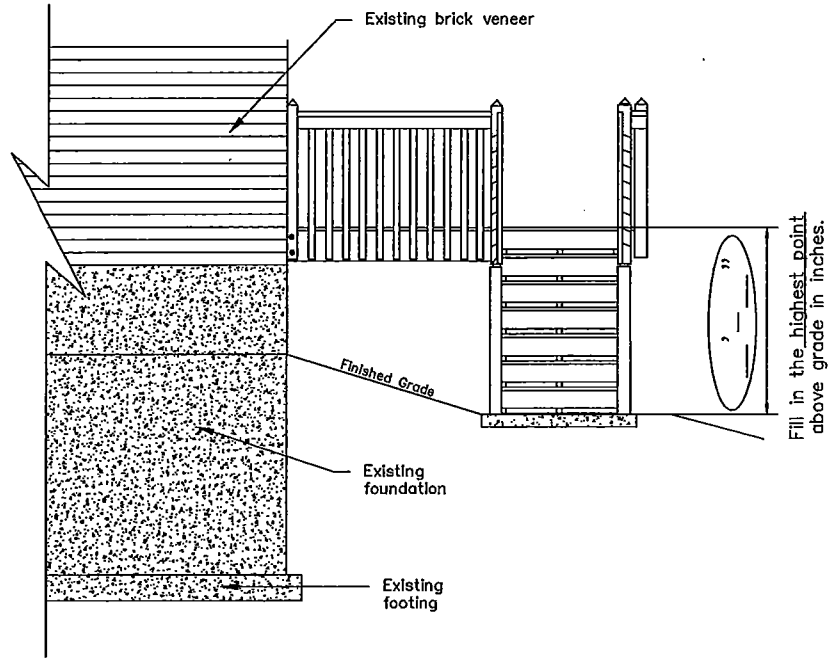

Stair
Section
View

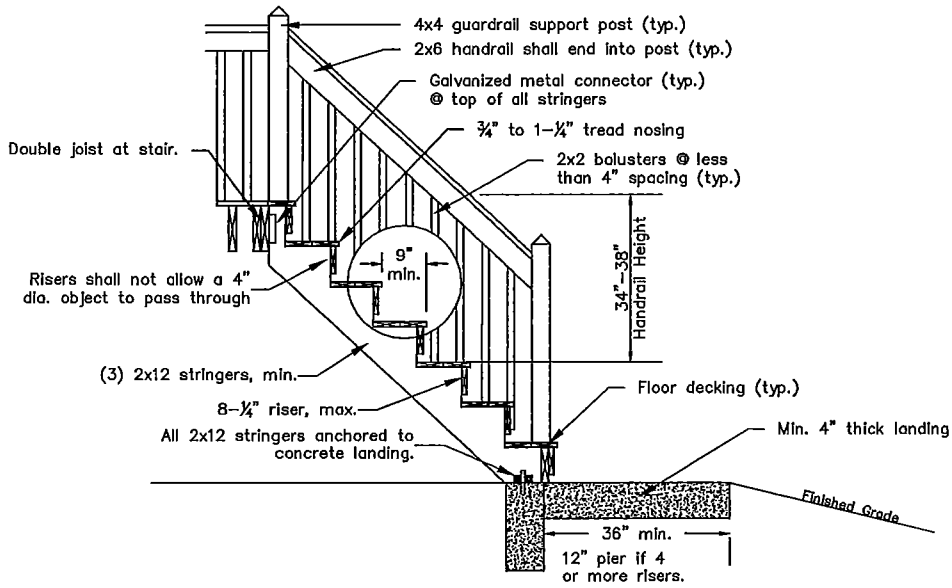

Handrail
Sections

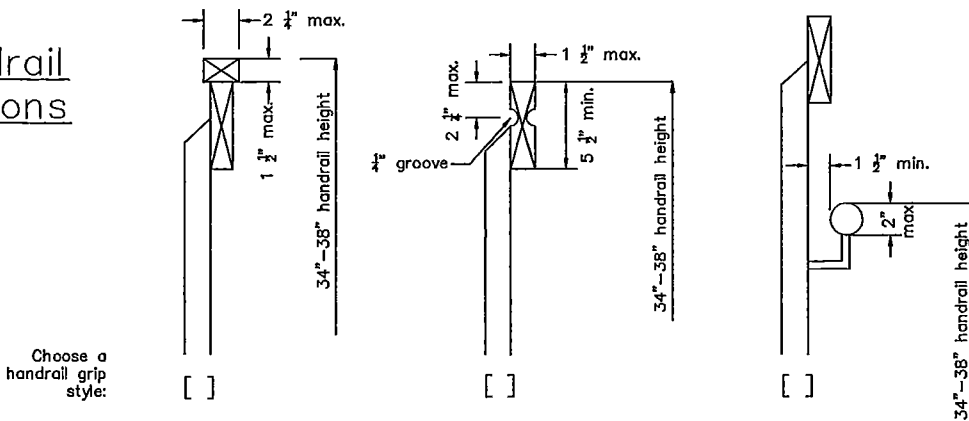

Application No.

Sheet No.

3



Post & Beam Detail

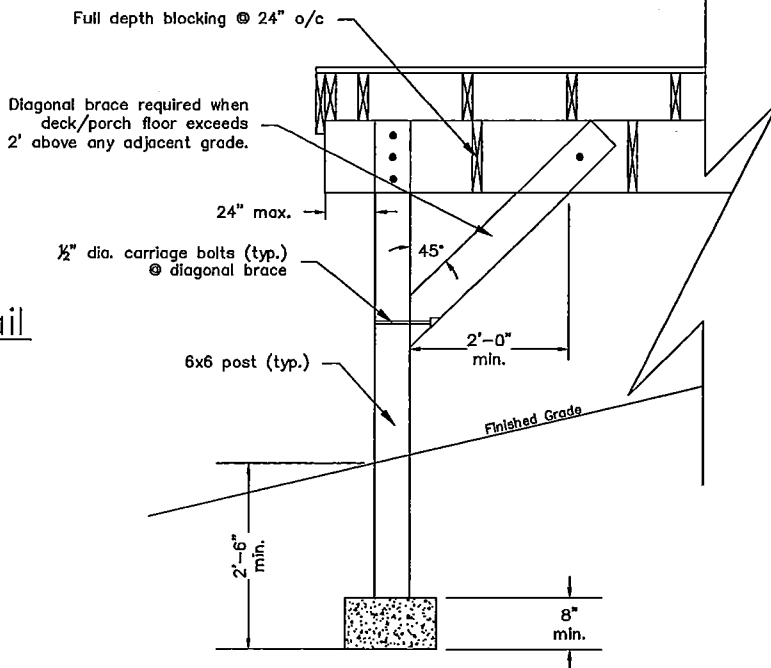

Ledger Board Details

Choose the ledger board that applies.

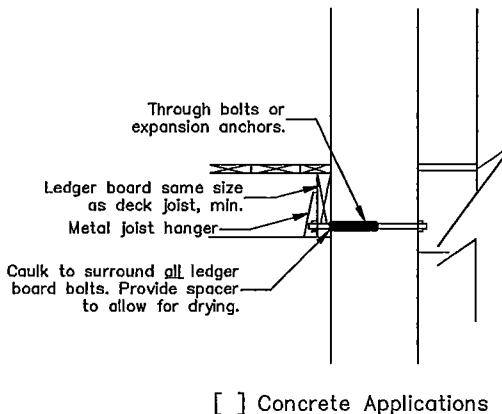
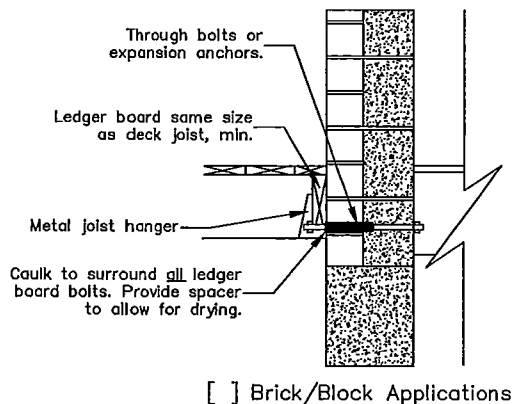
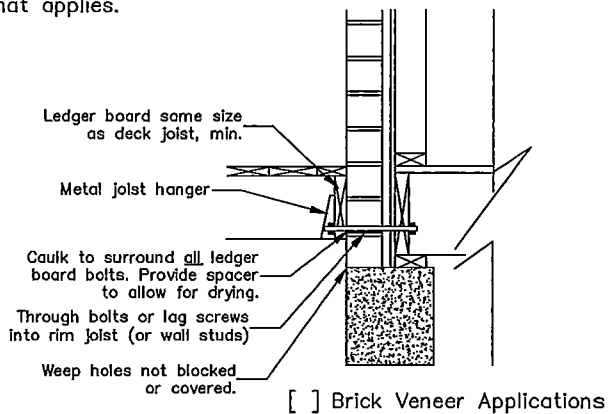
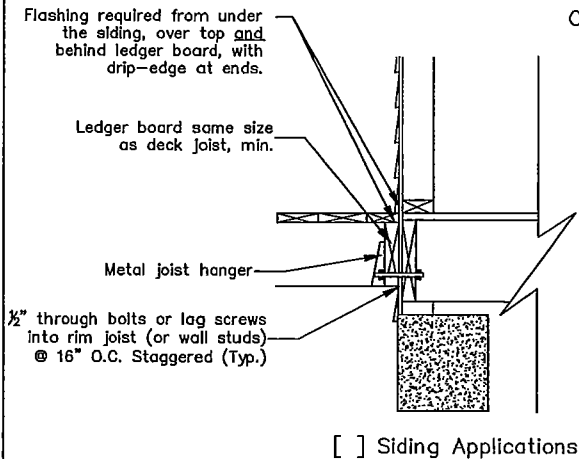

Application No.

Sheet No.

4

SITE PLAN

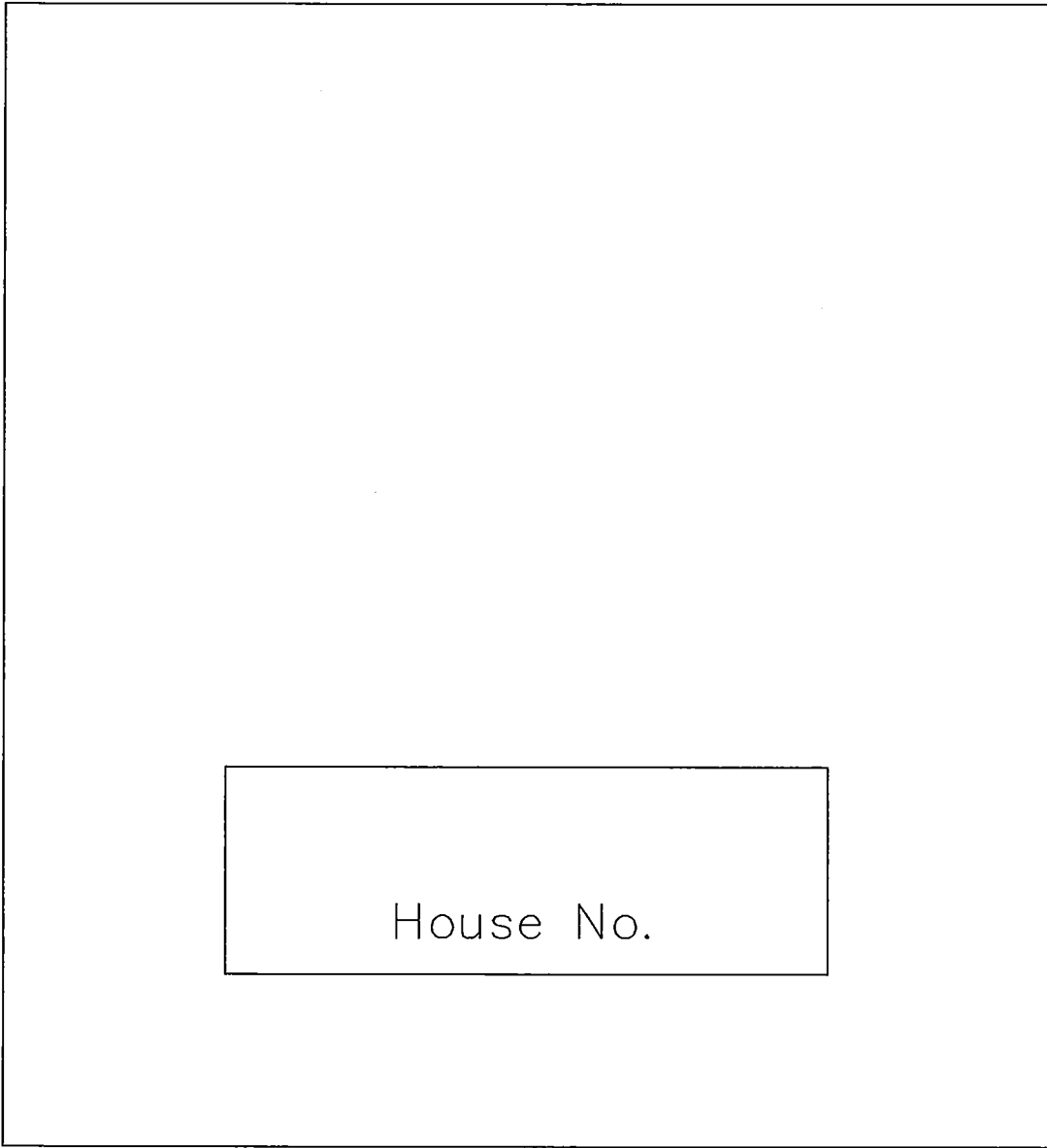

R

R

House No.

Curb Line

Street Centerline (Name)

Curb Line

Application No.

Sheet No.

5